

Stielhandgrenate 24

rocketmantan.deviantart.com

#65

Maquette en papier
Paper model kit
Kartonmodellbausatz



Known by its distinctive stick shape, the Model 24 grenade - more or less affectionately dubbed by the Allies as the "Potato Masher" - was the standard German grenade from WWI all the way to 1945. The design first saw use in 1915, its innovative stick shape providing the soldier with leverage that allowed the weapon to be thrown at far greater distances than other grenades of the time.

The standard method of operation called for the soldier to unscrew a cap at the end of a handle, which would reveal a small porcelain ball tied with a string to a friction igniter in the charge. The soldier would pull on this cord, thus activating a five-second fuze.

There were many field-adaptations of the grenade. These included a "splitterring" sleeve that could be fitted over the charge. When the grenade was detonated, the grooved sleeve would fragment, sending deadly shrapnel flying through the air. Another common adaptation was the "Geballte Ladung", five charges wrapped around one grenade.

Stielhandgrenate 24

Instructions

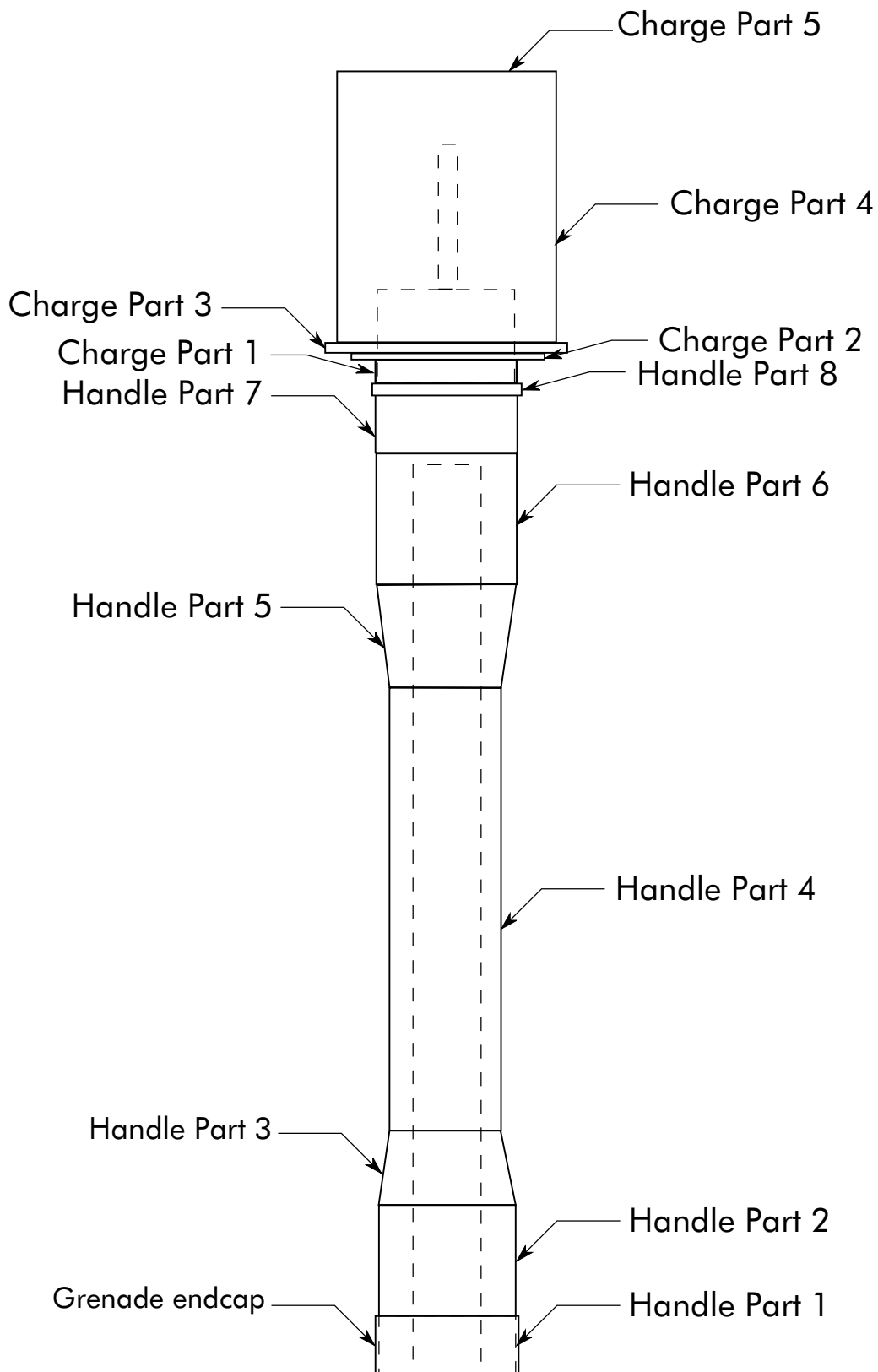

VOR GEBRAUCH SPRENGKAPSEL EINSETZEN

Part 4

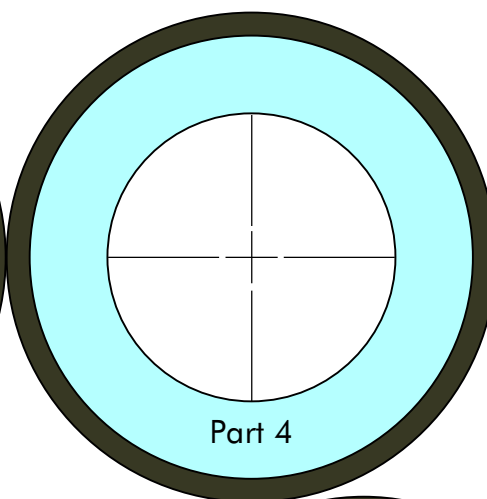
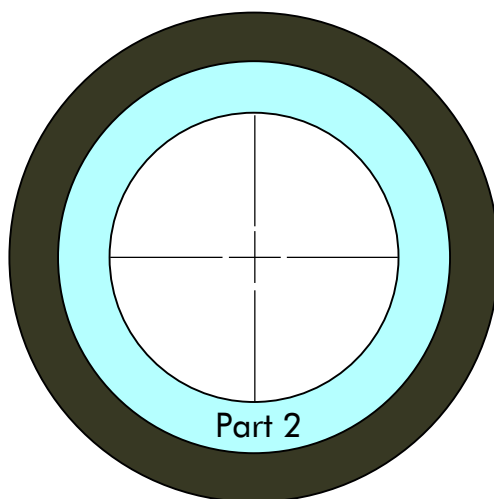

Part 3

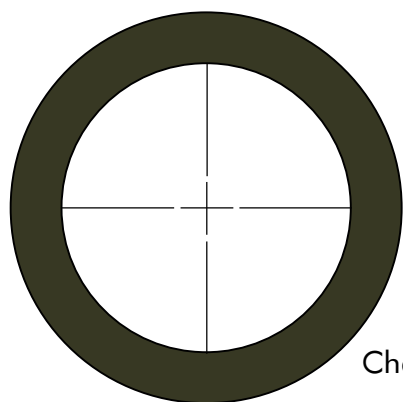

Charge part 2



Part 5



Charge part 1

Assemble parts 6b, 6c, and the fuse if you want to make a detachable warhead.

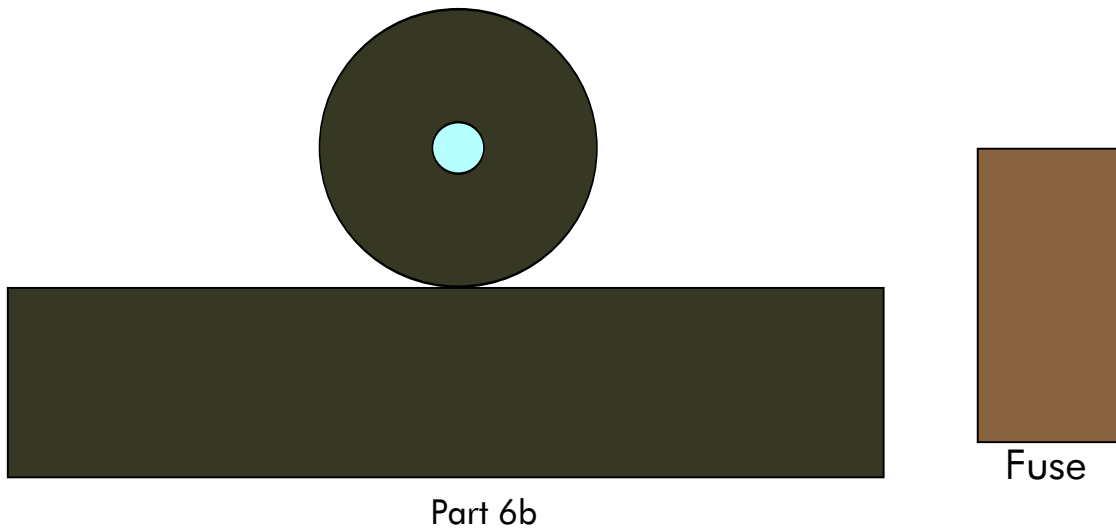

Wrap part 8 around blue strip on handle part 7

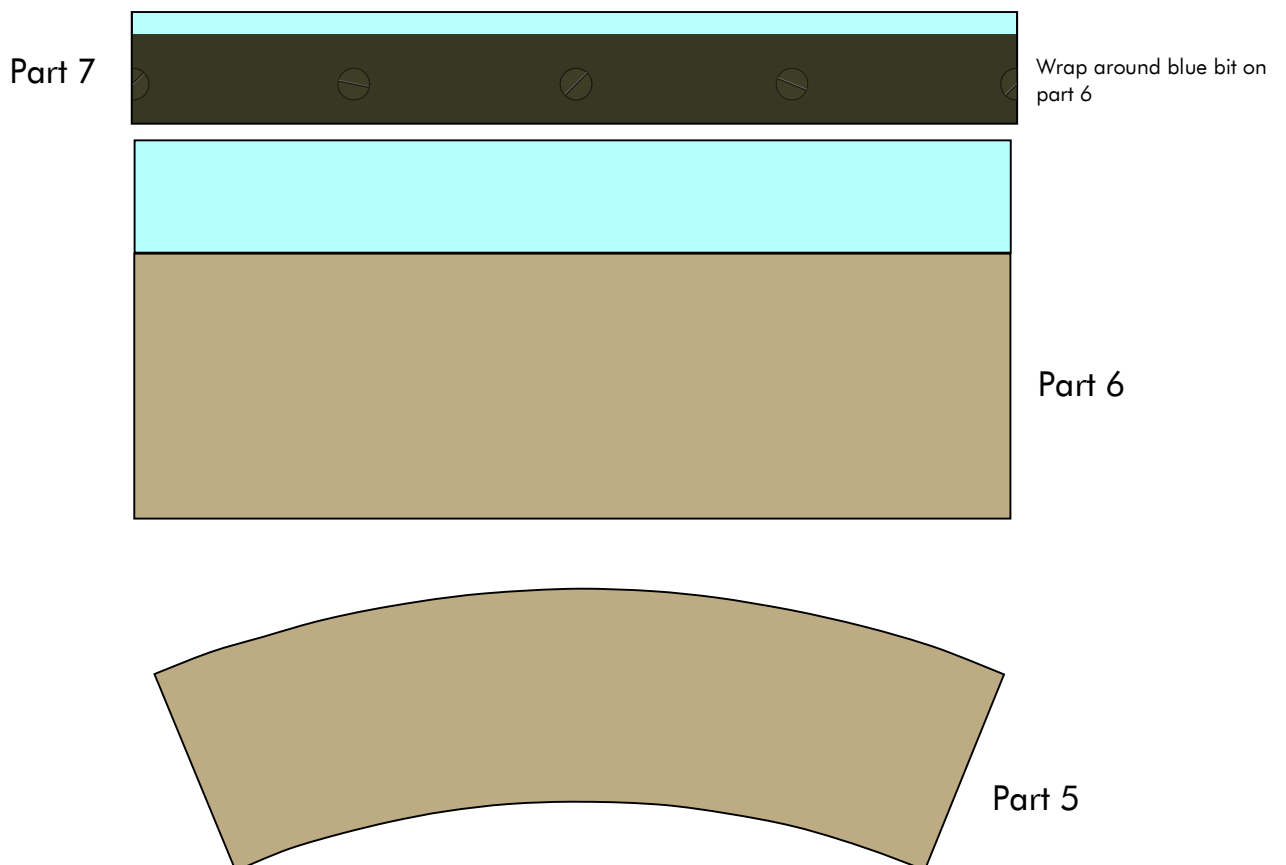



Part 4

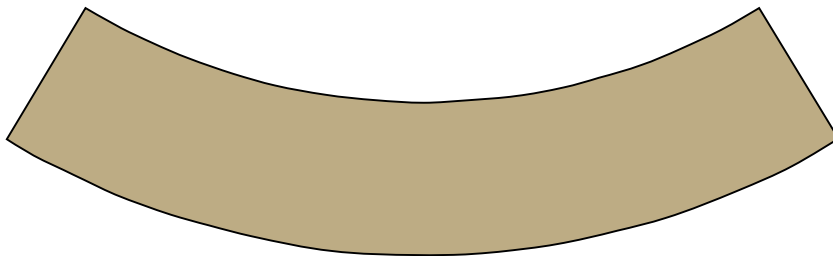

Part 3

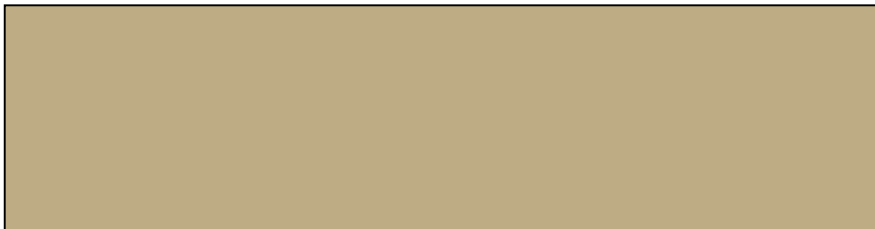

Part 2



Grenade handle part 1

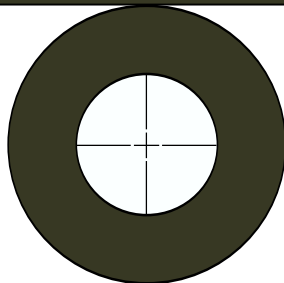

Grenade endcap

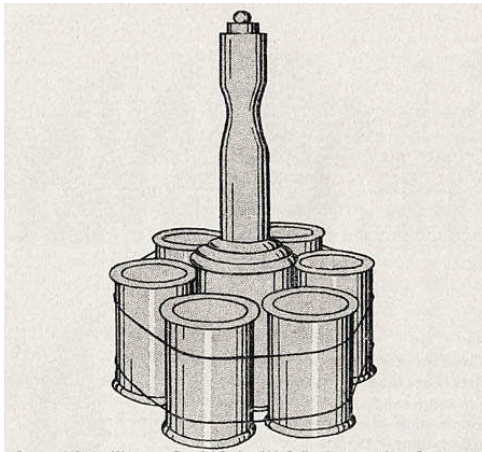
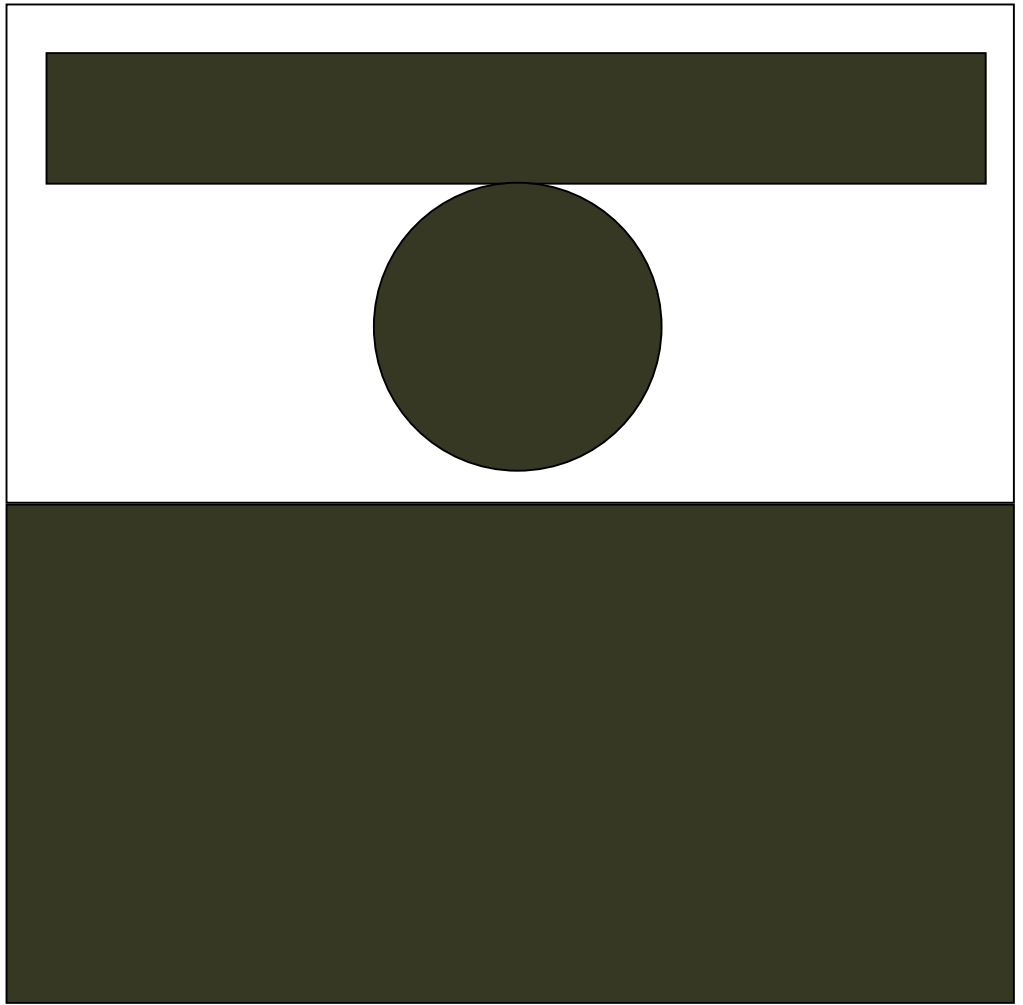

You can make the geballte ladung variant of the grenade by printing page three of the pdf seven times and wrapping six of the charges around the main grenade with wire or string.

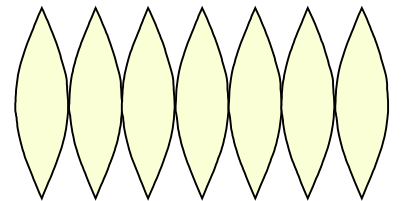

In order to arm the grenade, the soldier would pull on a porcelain ball tied to a string. This would pull on the friction operated fuze. Detonation occurred five seconds later.

(Optional) Interior barrel for drawstring